

Technical data sheet



Product features

Cooking range gas 2x burner ECO on open cabinet

Model	SAP Code	00110106
--------------	-----------------	----------



- Device type: Gas unit
- Power consumption of the zone 1 [kW]: 1x burner 3.5 kW
- Power consumption of the zone 2 [kW]: 1x burner 6 kW
- Protection of controls: IPX4
- Material: AISI 304 top plate, AISI 430 cladding

SAP Code	00110106	Power gas [kW]	9.500
Net Width [mm]	400	Type of gas	Natural gas, propane butane
Net Depth [mm]	700	Number of zones	2
Net Height [mm]	900	Power consumption of the zone 1 [kW]	1x burner 3.5 kW
Net Weight [kg]	28.00	Power consumption of the zone 2 [kW]	1x burner 6 kW

Technical data sheet



Technical drawing

Cooking range gas 2x burner ECO on open cabinet

Model

SAP Code

00110106

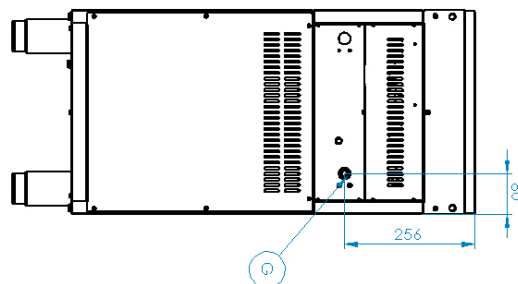
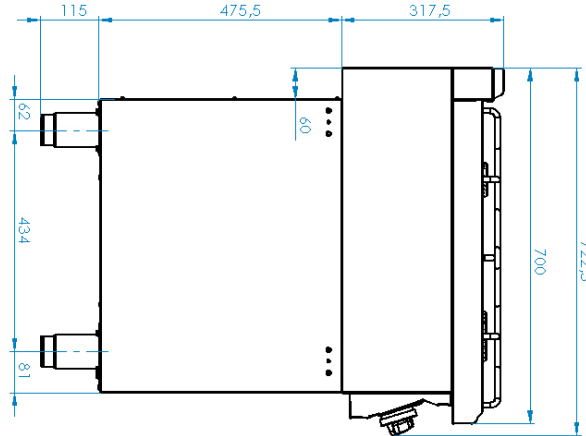
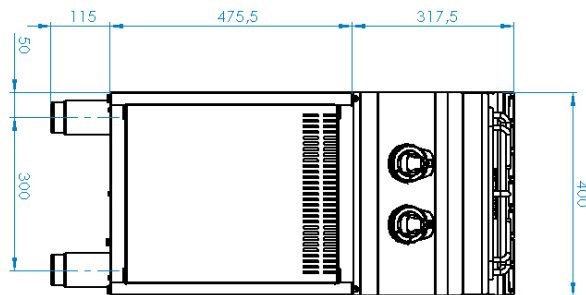

Cooking range gas 2x burner ECO on open cabinet

Model

SAP Code

00110106

1

Massive construction of burners

high performance and efficiency
cast iron burners removable
long life

- energy saving (perfect combustion)
- time saving for food preparation
- easy maintenance/cleaning

2

Hygienic moldings of the top plate

absence of sharp corners and edges (potential places where dirt could stick)
smooth transitions

- easy quick cleaning

3

Degree of protection of the control elements IPX4

maintenance-free system
resistance to splash water
long life

- savings on service interventions
- easy cleaning and maintenance of equipment

4

All-stainless design

long life
resistance of a ground steel plate with a thickness of 10 mm

- savings on service interventions
- higher corrosion resistance

5

Safety element - thermocouple

safe operation for personnel
there is no overheating and damage to the thallus
long life

- savings on service interventions
- easier and faster operation

6

Variability

the possibility of adding to the current line
easy possibility of creating one module
long life

- cost saving
- space saving
- long service life

Technical data sheet



Technical parameters

Cooking range gas 2x burner ECO on open cabinet

Model

SAP Code

00110106

1. SAP Code:

00110106

2. Net Width [mm]:

400

3. Net Depth [mm]:

700

4. Net Height [mm]:

900

5. Net Weight [kg]:

28.00

6. Gross Width [mm]:

440

7. Gross depth [mm]:

800

8. Gross Height [mm]:

975

9. Gross Weight [kg]:

36.00

10. Device type:

Gas unit

11. Construction type of device:

With substructure

12. Power gas [kW]:

9.500

13. Type of gas:

Natural gas, propane butane

14. Protection of controls:

IPX4

15. Material:

AISI 304 top plate, AISI 430 cladding

16. Worktop type:

Molded - comfortable cleaning maintenance

17. Worktop material:

AISI 304

18. Worktop Thickness [mm]:

1.20

19. Number of zones:

2

20. Power consumption of the zone 1 [kW]:

1x burner 3.5 kW

21. Power consumption of the zone 2 [kW]:

1x burner 6 kW

22. Grid material:

Cast iron

23. Service accessibility:

Trough the frontal panel

24. Safety thermocouple:

Yes

25. Adjustable feet:

Yes

26. Number of burners/hot plates:

2

27. Type of gas cooking zones:

Cast iron burners

28. Burner type:

Cast iron, detachable, with internal and external combustion